

Arbors

797

S mm	S ₁ mm	ORDER NO.
8	M10x1,5	797.580.00
10	M12x1	797.100.00
12	M12x1	797.120.00
12,7	M12x1	797.127.00

TECHNICAL DETAILS:

- Super strength steel
- Precisely machined for accuracy.



Collet chucks

796

S ₁ mm	D ₃ _For collet diameter mm	L mm	ORDER NO.
M10	6 - 6,35 - 8 - 9,5	38	796.100.00
M12x1	6 - 6,35 - 8 - 9,5	38	796.000.00
M12x1	10 - 12 - 12,7	47	796.121.00

TECHNICAL DETAILS:

- Super strength steel
- Precisely machined for accuracy.

Collet not included.



Router chuck extensions with collet

796.001/002

S mm	D ₃ _Collet diameter mm	L mm	ORDER NO.
12	8	81	796.002.01
12	12	88	796.002.00
12,7	6,35	81	796.001.01
12,7	12,7	88	796.001.00

TECHNICAL DETAILS:

- Super strength steel
- Precisely machined for accuracy.

Collet included

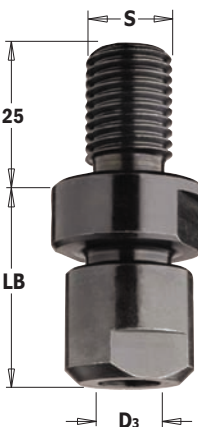

Collet chucks

796

S mm	D ₃ _For collet diameter mm	LB mm	ORDER NO.
M14x2	6 - 6,35 - 8 - 9,5	32	796.140.00
M14x2	10 - 12 - 12,7	38	796.141.00
M16x2	6 - 6,35 - 8 - 9,5	32	796.160.00
M16x2	10 - 12 - 12,7	38	796.161.00

TECHNICAL DETAILS:

- Super strength steel
- Precisely machined for accuracy.

Collet not included



Collets

796.500/600

D ₃ mm	ORDER NO.	D ₃ mm	ORDER NO.
6	796.560.00	10	796.600.00
6,35	796.564.00	12	796.620.00
8	796.580.00	12,7	796.627.00
9,5	796.595.00		

Spare part and Accessories



Arbors

798

S mm	S ₁ mm	ORDER NO.
M10	M10	798.101.00
M10	M12x1	798.102.00
M12x1	M10	798.121.00
M12x1	M12x1	798.122.00

TECHNICAL DETAILS:
 - Super strength steel
 - Precisely machined for accuracy.

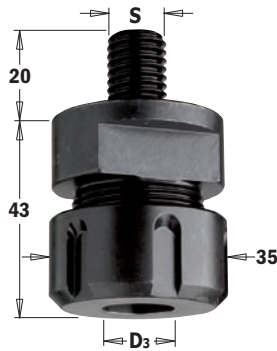

“ER20” chucks

796

S mm	D_For collet diameter mm	LB mm	ORDER NO.
M12x1,75	3 ~ 12,7	43	796.122.00
M14x2	3 ~ 12,7	43	796.142.00
M16x2	3 ~ 12,7	43	796.162.00

Spare parts: 992.483.03 M25x1,5mm clamping nut
 991.483.00 “ER20” key

TECHNICAL DETAILS:
 Super strength steel. Precisely machined for accuracy.

Collet not included

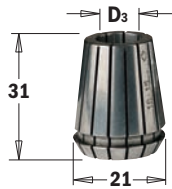

“ER20” precision collets for 796.122/142/162 items

184

D ₃ mm	ORDER NO.	D ₃ mm	ORDER NO.
3	184.030.20	10	184.100.20
6	184.060.20	12	184.120.20
6,35	184.064.20	12,7	184.127.20
8	184.080.20		

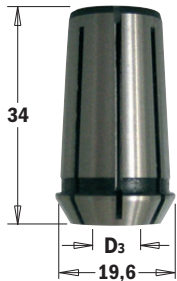

Collets for CMT1E, CMT2E, DeWalt, Felisatti, Fein, Metabo hand-held routers

796.8

D ₃ mm	ORDER NO.	D ₃ mm	ORDER NO.
6	796.860.00	10	796.900.00
6,35	796.864.00	12	796.920.00
8	796.880.00	12,7	796.927.00
9,5	796.895.00		

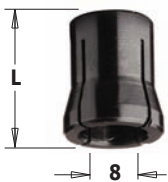

Collets for Freud/Casals hand-held routers

796.780

D ₃ mm	L mm	ORDER NO.
8	14	796.780.00

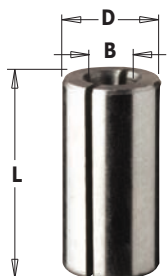

Bushings

799

B mm	D mm	L mm	ORDER NO.	B mm	D mm	L mm	ORDER NO.
6	8	25	799.060.00	8	10	25	799.280.00
6	9,5	25	799.160.00	8	12	25	799.380.00
6	12	25	799.260.00	8	12,7	25	799.480.00
6,35	8	25	799.064.00	9,5	12,7	25	799.001.00
6,35	9,5	25	799.164.00	10	12	25	799.100.00
6,35	12,7	25	799.264.00	13	16	45	799.130.00
8	9,5	25	799.180.00				

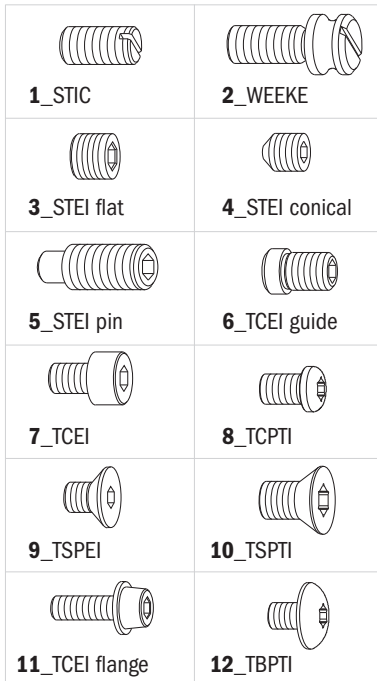

Screws

990

D mm	REFERENCE	ORDER NO.	D mm	REFERENCE	ORDER NO.
M5x8	1_STIC	990.008.00	1/8Wx1/2"	7_TCEI	990.059.00
M5x10	1_STIC	990.003.00	M5x10	7_TCEI	990.010.00
M5x11,5x17	2_WEEKE	990.088.00	M4x6	9_TSPEI	990.004.00
M4x20	3_STEI	990.091.00	M5x12	9_TSPEI	990.055.00
M5x4	3_STEI	990.015.00	M5x12x18	9_TSPEI	990.063.00
M5x5 flat	3_STEI	990.001.00	M5x8	9_TSPLIC	990.067.00
M3x3	4_STEI	990.005.00	M6x7,5	9_TSPEI	990.083.00
M5x5 conical	4_STEI	990.002.00	M1/4"x7/8"	9_TSPEI	990.097.00
M6x6	4_STEI	990.007.00	1/8Wx3/8"	11_TCEI	990.058.00
M6x8	5_STEI	990.087.00	Torx screw		
M6x16	5_STEI	990.066.00	M3x4x5,7	8_TCPTI	990.082.00
M6x20	5_STEI	990.084.00	M4x4,5x8	8_TCPTI	990.094.00
M6x25	5_STEI	990.085.00	M2,5x3x4,5	10_TSPTI	990.070.00
M8x16	5_STEI	990.064.00	M2,5x4,5x6	10_TSPTI	990.071.00
M8x12	5_STEI	990.065.00	M4x2x3	10_TSPTI	990.079.00
M8x20	5_STEI	990.086.00	M5x4,75x6,5	10_TSPTI	990.080.00
M5x5 D6	6_STEI	990.068.00	M5x5x8	10_TSPTI	990.093.00
M2,5x6x8,5	7_TCEI	990.062.00	M3,5x3,5x6	12_TBPTI	990.072.00
M3x6	7_TCEI	990.051.00	M3,5x5x7,2	12_TBPTI	990.073.00
M3x10	7_TCEI	990.053.00	M3,5x6x8,5	12_TBPTI	990.077.00
M3x16	7_TCEI	990.054.00	M4x3,5x5,7	12_TBPTI	990.074.00
M4x6	7_TCEI	990.052.00	M4x4x6,2	12_TBPTI	990.056.00
M4x12x16	7_TCEI	990.061.00	M4x4x6,2	12_TBPTI	990.076.00
M6x25	7_TCEI	990.098.00	M4x6x8	12_TBPTI	990.078.00
M8x25	7_TCEI	990.099.00	M4x6x8,2	12_TBPTI	990.075.00

Keys for screws

991

DESCRIPTION	ORDER NO.	DESCRIPTION	ORDER NO.
Hex keys		6mm hex key	991.066.00
3/32" hex key (for 1/8W screws)	991.057.00	Torx key	
1,5mm hex key (for M3 screws)	991.056.00	T8 Torx key	991.063.00
2mm hex key	991.060.00	T9 Torx key	991.069.00
2,5mm hex key (for M4 screws)	991.062.00	T15 Torx key	991.061.00
3mm hex key	991.067.00	T20 Torx key	991.072.00
4mm hex key	991.064.00	T25 Torx key	991.073.00
5mm hex key	991.065.00	T30 Torx key	991.071.00

Shields for bearings

990.422/423

DESCRIPTION	ORDER NO.	DESCRIPTION	ORDER NO.
Ø9,5mm shield	990.422.00	Ø12,7mm shield	990.423.00

Nuts for arbors

990.0

DESCRIPTION	ORDER NO.	DESCRIPTION	ORDER NO.
Nut for M4 thread arbor	990.092.00	Nut for M8 thread arbor	990.020.00
Nut for M6 thread arbor	990.095.00	Nut for M12x1,25mm thread arbor	990.022.00

Stop collars

541

B mm	ORDER NO.	B mm	ORDER NO.
6	541.003.00	9,5	541.006.00
6,35	541.001.00	12	541.005.00
8	541.004.00	12,7	541.002.00

Spare part and Accessories

791

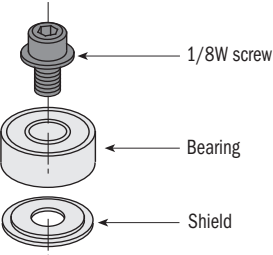

Be Sure: to keep the black washer right side up to correspond with the bearing rotation during reassembly.



***10° Delrin® conical bearing**



****Delrin® triangular bearing**



*****Delrin® cylindrical bearings**

Bearings

D		B		Thickness mm	ORDER NO.
mm	inches	mm	inches		
6,35	1/4	3,17	1/8	2,8	791.035.00
9,5	3/8	4,76	3/16	3,2	791.002.00
12,7	1/2	4,76	3/16	5	791.003.00
12,7	1/2	6,35	1/4	4,8	791.010.00
13		5		4	791.022.00
13		6		5	791.023.00
15		6		5	791.024.00
15,8	5/8	4,76	3/16	5	791.018.00
15,8	5/8	6,35	1/4	5	791.009.00
16		5		5	791.006.00
16		8		5	791.025.00
19	3/4	4,76	3/16	7,5	791.019.00
19		6		6	791.007.00
19	3/4	6,35	1/4	7	791.004.00
19		8		6	791.034.00
19	3/4	12,7	1/2	4	791.011.00
22		8		6	791.012.00
22		8		7	791.005.00
22,2	7/8	4,76	3/16	7,5	791.017.00
22,2	7/8	9,52	3/8	7	791.021.00
22,2	7/8	12,7	1/2	7	791.013.00
24		8		8	791.036.00
28		12		8	791.026.00
28,5	1-1/8	4,76	3/16	8,4	791.014.00
28,5	1-1/8	8		8,5	791.030.00
28,5	1-1/8	12,7	1/2	8	791.027.00
31,7	1-1/4	8		5	791.033.00
31,7	1-1/4	12,7	1/2	10	791.015.00
34,9	1-3/8	4,76	3/16	11,5	791.016.00
34,9	1-3/8	8		11,6	791.031.00
34,9	1-3/8	12,7	1/2	11	791.029.00
37		12		12	791.028.00
38,1	1-1/2	12,7	1/2	13,3	791.020.00
62		30		16	791.051.00
62		35		14	791.052.00
80		40		18	791.054.00
80		50		16	791.053.00
10° Delrin® conical bearings					
19	3/4	4,76	3/16	6,8	791.041.00*
Delrin® triangular bearings					
12,7	1/2	4,76	3/16	5,8	791.042.00**
19	3/4	4,76	3/16	7	791.043.00**
Delrin® cylindrical bearings					
12,7	1/2	4,76	3/16	5	791.044.00***
15,87	5/8	4,76	3/16	7,2	791.045.00***
19,05	3/4	4,76	3/16	6,8	791.046.00***

NEW

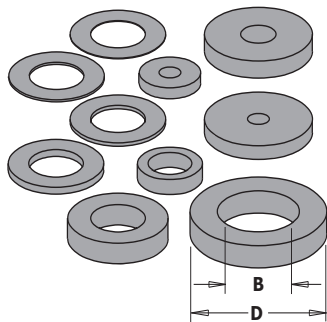

Shields for assembly

541

B mm	D mm	Thickness mm	ORDER NO.	B mm	D mm	Thickness mm	ORDER NO.
3,25	9	1,6	541.550.00	8	14,7	5,8	541.519.00
3,25	15,8	2	541.552.00	12	20	2	541.512.00
5,2	15,8	2,5	541.551.00	12	20	3	541.511.00
6,4	9,52	2,2	541.514.00	12	21	0,1	541.513.00
8	14	0,1	541.515.00	12	21	0,3	541.520.00
8	14	0,3	541.516.00	12	21	1,59	541.521.00
8	14	0,5	541.517.00	12	21	3,18	541.522.00
8	14	1	541.518.00	12	21	6,16	541.523.00
8	14,7	3	541.500.00	12	21	1	541.524.00
8	14,7	4	541.501.00	12	21	0,5	541.525.00

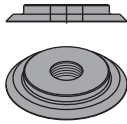

Threaded rings for 694.001 cutter heads

695.996

DESCRIPTION	ORDER NO.
M4 threaded ring (Ø10x1,6mm)	695.996.01
M4 threaded ring (Ø12x1,7mm)	695.996.02

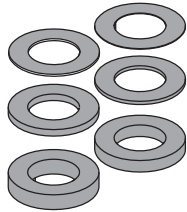

SPACER SETS

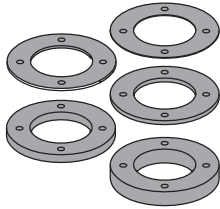

SPACER SETS WITH PIN HOLE

Spacers set

695.998

DESCRIPTION	FOR CUTTER HEAD	ORDER NO.
Ø50x9x30mm spacer set	694.015	695.998.01
Ø50x9x31,75mm spacer set	694.015	695.998.02
Ø55x9x35mm spacer set	694.015	695.998.03
Ø60x9x40mm spacer set	694.015	695.998.04
Ø70x9x50mm spacer set	694.015	695.998.05
Ø50x33x30mm spacer set	694.005	695.998.11
Ø50x33x31,75mm spacer set	694.005	695.998.12
Ø55x33x35mm spacer set	694.005	695.998.13
Ø60x33x40mm spacer set	694.005	695.998.14
Ø70x22x50mm spacer set	694.005	695.998.15
Pin Hole		
Ø65x8x30mm spacer set	694.001 and 694.015	695.998.21
Ø65x8x31,75mm spacer set with pin hole	694.001 and 694.015	695.998.22
Ø65x8x35mm spacer set with pin hole	694.001 and 694.015	695.998.23
Ø70x8x40mm spacer set with pin hole	694.001 and 694.015	695.998.24N
Ø70x8x50mm spacer set with pin hole	694.001 and 694.015	695.998.25N

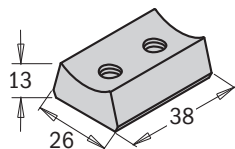
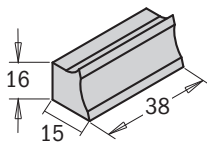

Wedges for cutter heads

651-692-693-695

DESCRIPTION	ORDER NO.	DESCRIPTION	ORDER NO.
Wedge for cutter heads			
38x15x16mm wedge	692.999.01	31x11x9,5mm wedge	695.999.31
38x22,5x13mm wedge	692.999.02	38x11x9,5mm wedge	695.999.38
38x26x13mm wedge	693.999.01	39x11x9,5mm wedge	695.999.39
38x28x12,5mm wedge	693.999.02	41x11x9,5mm wedge	695.999.41
38x15x16mm wedge (for cutter heads)	695.018.01	42x11x9,5mm wedge	695.999.42
7x11x9,5mm wedge	695.999.07	46x11x9,5mm wedge	695.999.46
16x11x9,5mm wedge	695.999.16	49x11x9,5mm wedge	695.999.49
17x11x9,5mm wedge	695.999.17	53x11x9,5mm wedge	695.999.53
22x11x9,5mm wedge	695.999.22	Wedges for router bits with knives	
23x11x9,5mm wedge	695.999.23	D=8x20mm wedge	651.999.01
23x11x9,5mm wedge	695.999.24	D=10-12-12,7x30mm wedge	651.999.02
		D=12-12,7x50mm wedge	651.999.03

Slot cutter arbors

7/8/924

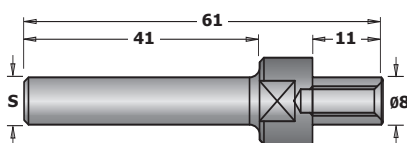
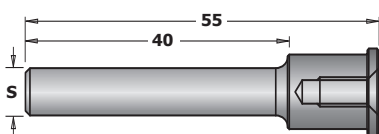
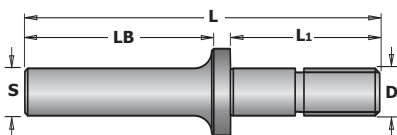

D mm	L1 mm	LB mm	L mm	ORDER NO. S=Ø6mm	ORDER NO. S=Ø6,35mm	ORDER NO. S=Ø8mm	ORDER NO. S=Ø12mm	ORDER NO. S=Ø12,7mm
Arbors for 822 slot cutters								
M8	26	32	61	724.060.00	824.064.00	924.080.00		
M8	40	38	86			924.083.00		
M8	26	38	67,5				924.120.00	824.127.00
M8	40	38	81				924.128.00	824.128.00
M12	54	38	97				924.129.00	824.129.00
M8	47	38	97				924.130.00	824.130.00
M8	29,75	32	71				924.131.00	824.131.00
M8	35,5	28,5	71				924.132.00	824.132.00
M8	23	41	71				924.133.00	824.133.00
M12	39,5	38	85				924.134.00	824.134.00
M12	54,5	38	100					824.135.00
Arbors for 823 slot cutters with counterbore								
		40	55	724.061.00	824.061.00	924.081.00		824.121.00
8	11	41	61	724.062.00	824.062.00	924.082.00		824.122.00